

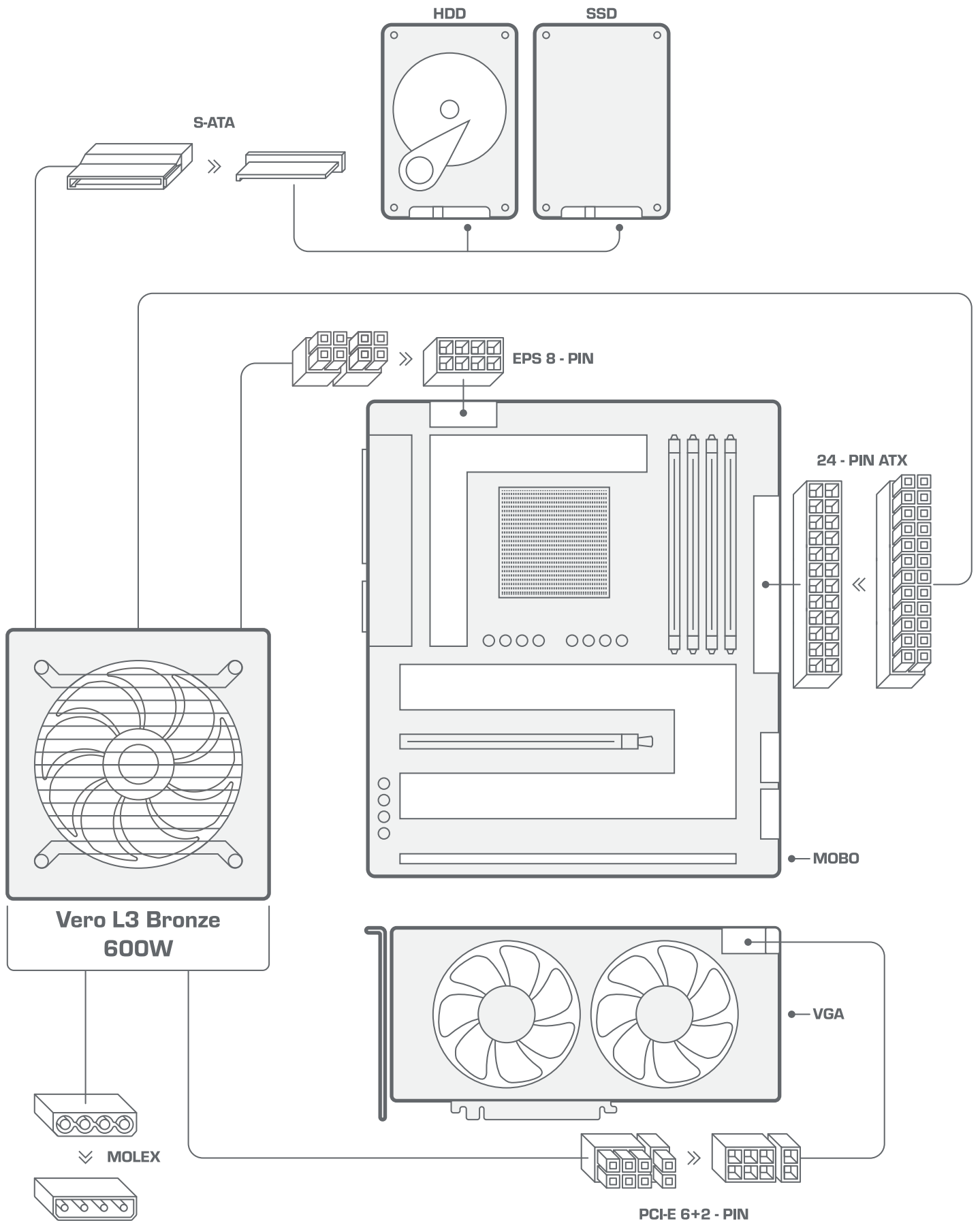

SILENTIUMPC

MANUAL

Vero L3 Bronze 600W



Vero L3 Bronze 600W

AC INPUT / WEJŚCIE 200 - 240 V, 5 A, 50 Hz Active PFC
ATX 12V 2.31, EPS 12V 2.91/2.92 and older

DC Output	+12V	+3.3V	+5V	-12V	+5VSB
Max A	49	15	15	0.3	2.5
Max W	588	97	3.6	12.5	
Total	600W				

