

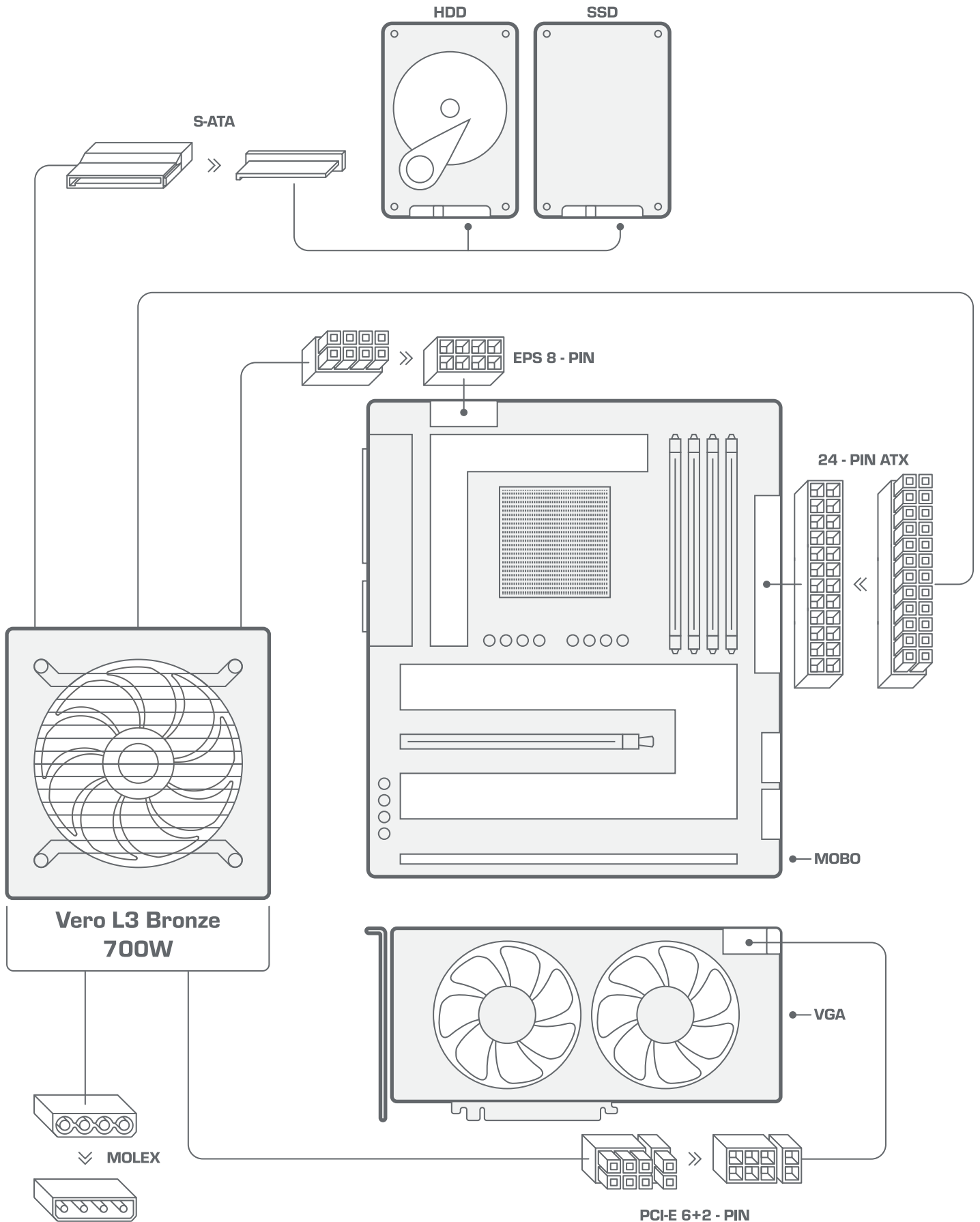

SILENTIUMPC

MANUAL

Vero L3 Bronze 700W



Vero L3 Bronze 700W

AC INPUT / WEJŚCIE 200-240V, 6A, 50Hz Active PFC
ATX 12V 2.31 EPS 12V 2.91/2.92 and older

DC Output	+12V	+3.3V	+5V	-12V	+5VSB
Max A	58	15	15	0.3	2.5
Max W	696	97	3.6	12.5	
Total	700W				

