

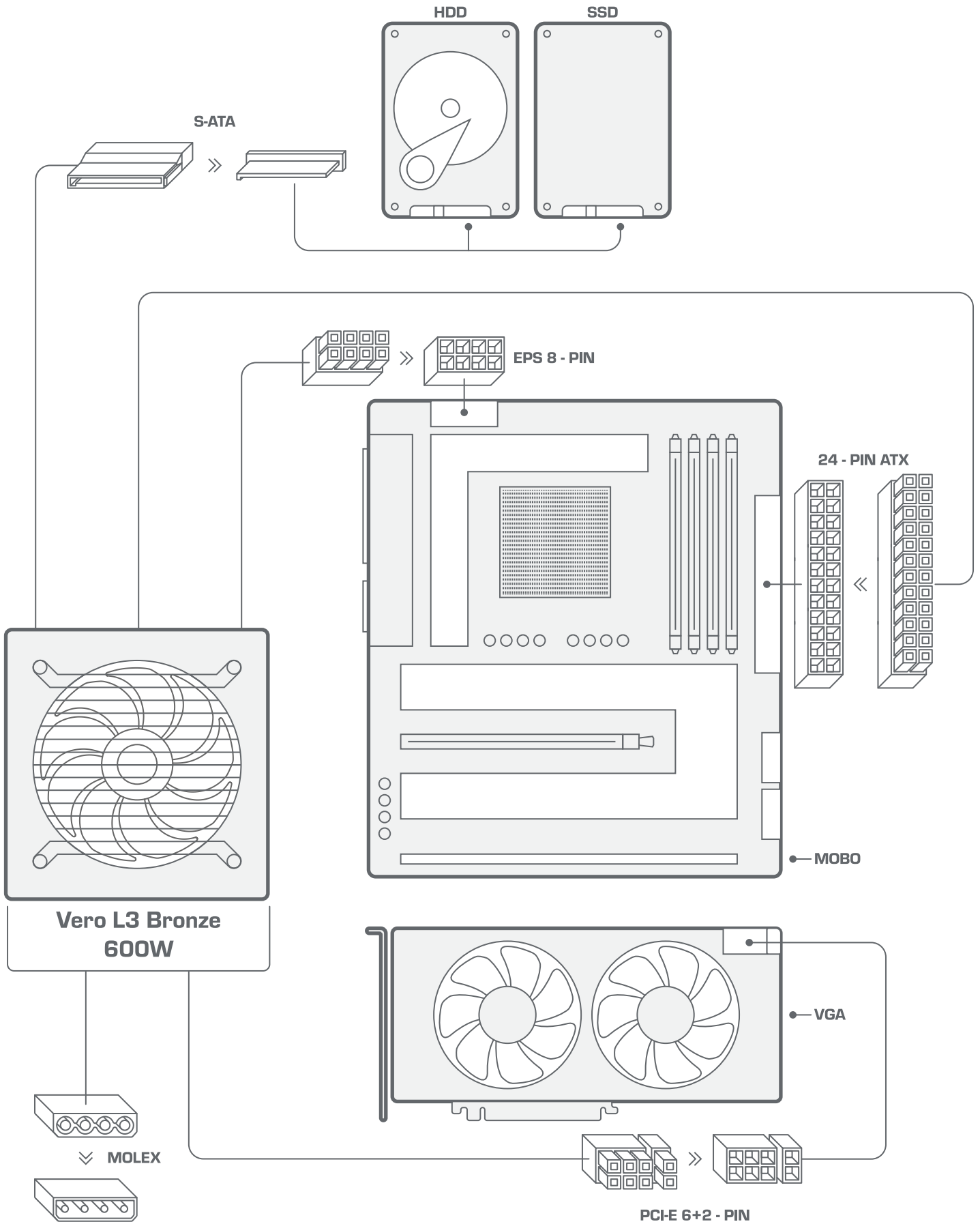

SILENTIUMPC

# MANUAL

Vero L3 Bronze 600W



# Vero L3 Bronze 600W

AC INPUT / WEJŚCIE 200-240V, 5A, 50Hz Active PFC  
ATX 12V 2.31 EPS 12V 2.91/2.92 and older

DC Output	+12V	+3.3V	+5V	-12V	+5VSB
Max A	49	15	15	0.3	2.5
Max W	588	97	3.6	12.5	
<b>Total</b>	<b>600W</b>				

