

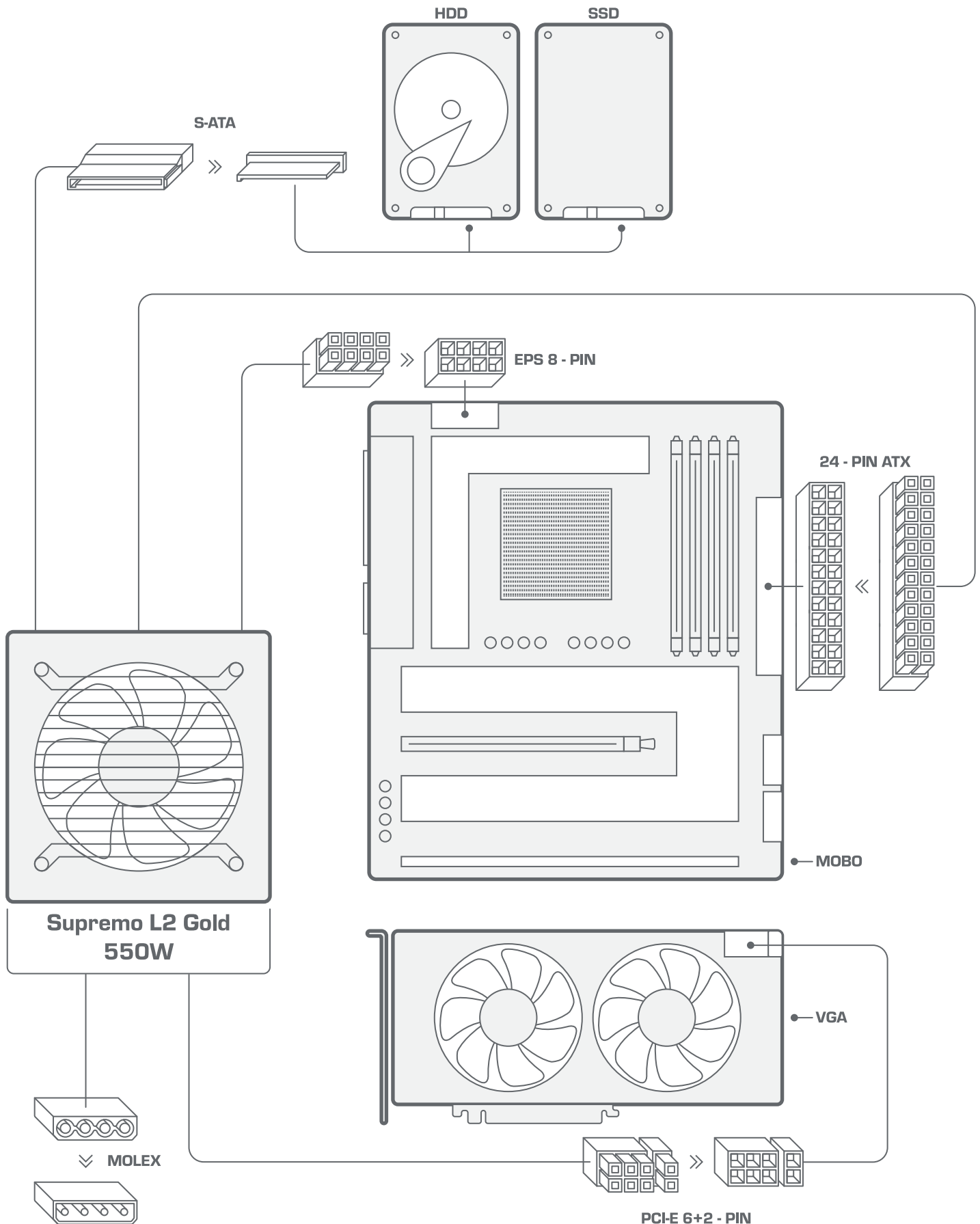

SILENTIUMPC

MANUAL

Supremo L2 Gold 550W



Supremo L2 Gold 550W

AC INPUT / WEJŚCIE 100~240V, 12-6A, 63Hz-47Hz Active PFC
ATX 12V 2.31 EPS 12V 2.91/2.92 and older

DC Output	+12V	+3.3V	+5V	-12V	+5VSB
Max A	44	24	15	0.3	3
Max W	528	100	3.6	15	
Total	550W				

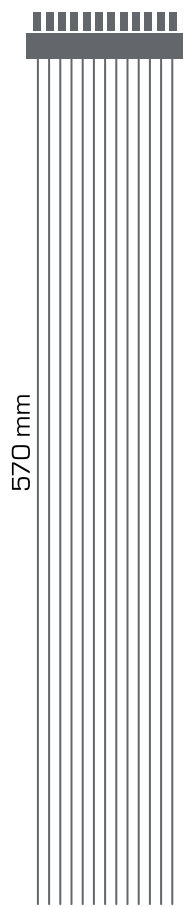
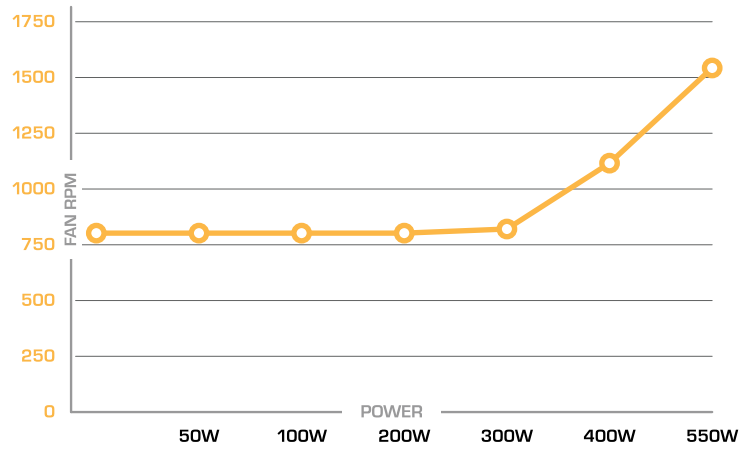

24 - PIN ATX



EPS 8 - PIN

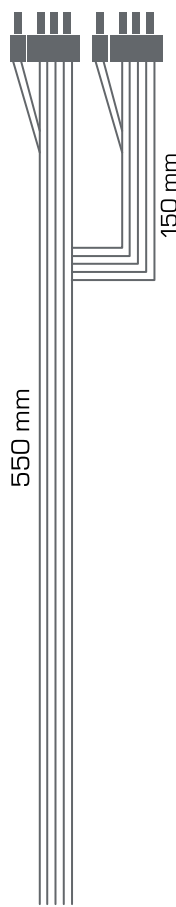

PCI-E (6+2 - PIN)
VGA

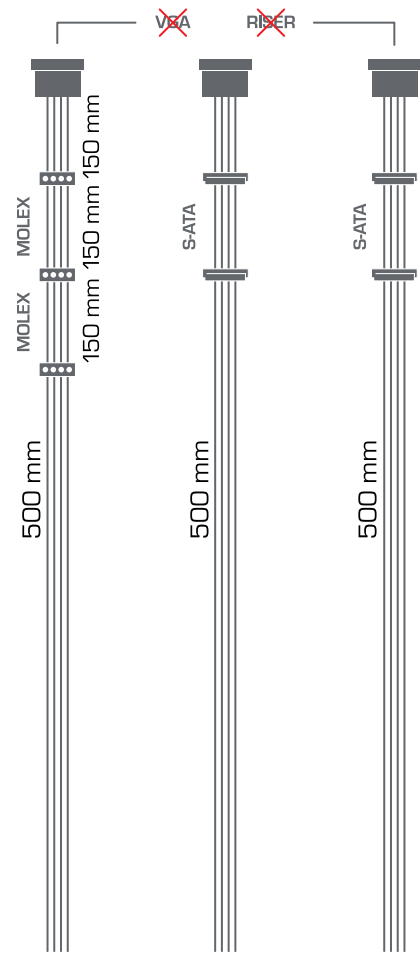

S-ATA/IDE

S-ATA

S-ATA

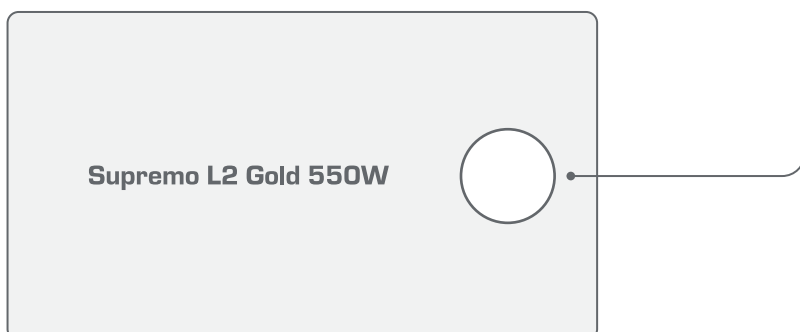

Supremo L2 Gold 550W